

FLOATING

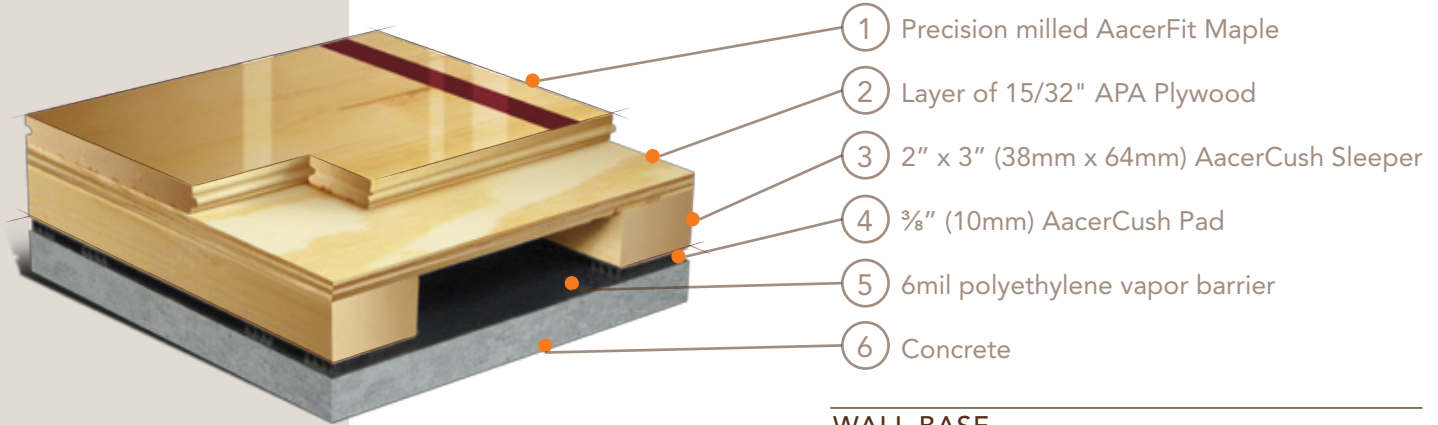

AacerCush I+

AacerCush I+ is a shock absorbent variable profile system. This system combines sleepers with a plywood layer for greater dimensional strength. This system is ideal for new and retrofit commercial and athletic applications.



Green Status
LEED Contributors



FSC Maple - MRc7
FSC SubFloor Components - MRc7
EQ Regional materials MRc5.1 & 5.2

| | |
|-----------------------|---|
| Resiliency | AacerCush PVC Pads |
| Slab Depression | <p>3/8" (10mm) PVC Pad 25/32" (20mm) flooring – 3 1/8" (80mm) 33/32" (26mm) flooring – 3 3/8" (86mm)</p> <p>5/8" (16mm) PVC Pad 25/32" (20mm) flooring – 3 3/8" (86mm) 33/32" (26mm) flooring – 3 5/8" (92mm)</p> |
| Subfloor Construction | Sleeper Plywood |
| System Type | Floating System |
| Testing Laboratory | |
| Warranty | Lifetime available |

WALL BASE

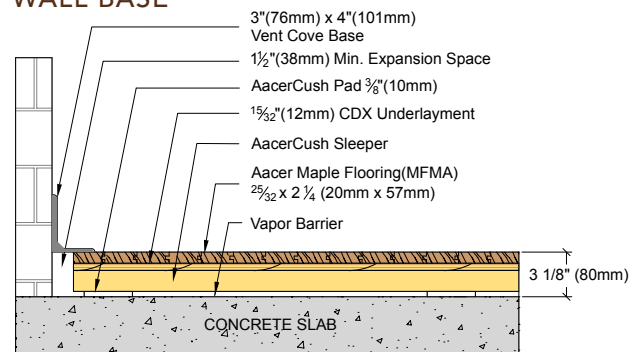

THRESHOLD

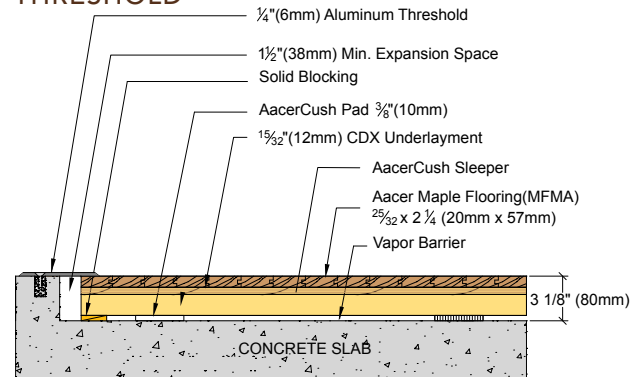

EQUIPMENT

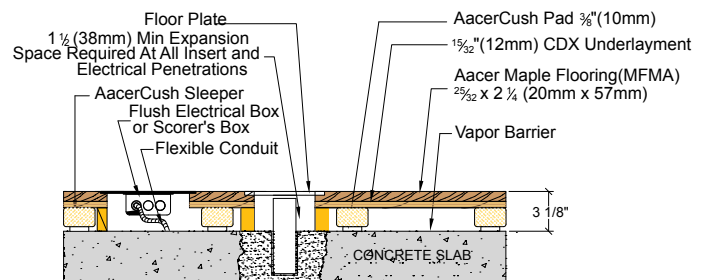

AacerFlooring.com (877) 582-1181

It is the policy of Aacer Flooring to continuously improve its line of products. Therefore, Aacer Flooring reserves the right to change, modify or discontinue systems, specifications and accessories of all products at any time without notice or obligation to purchaser.