



# AACER

SPORTS FLOORING

## TriPower™ Pad

The next generation in a sports performance pad, Aacer's new TriPower™ Pad provides EN, DIN and PUR certified performance with increased load handling. The TriPower™ Pad's unique, wide stance gives greater response consistency and lower vibration than other pad designs.

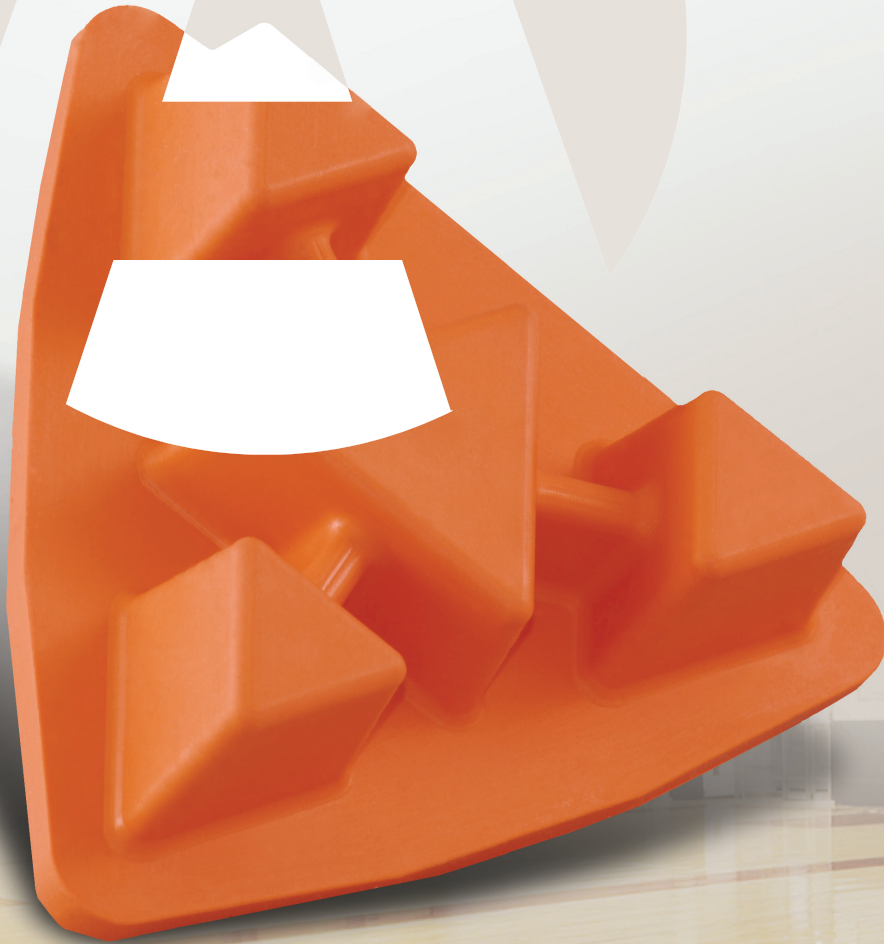

see us at  
**Sweets.com**



The mark of  
responsible forestry







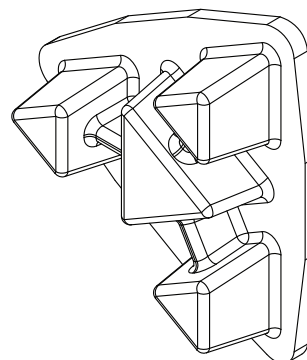
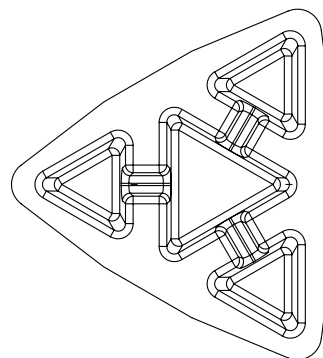

## TriPower™ Pad

TriPower™ Pad offers superior shock absorption and vibration dampening. The unique blend of EPDM ensures stability and longevity required by high performance floors.

- ① Structural Webs - Cross Linked
  - a. Greater load carrying ability
  - b. Vibration attenuation
  - c. Increased uniformity & consistent response
- ② Stage II Heavy-Duty Load Distribution
- ③ 3 Point Surface Contact Shock Pads - Athletic Resilience

### DETAIL DRAWINGS



|                       |   |
|-----------------------|---|
| Composition           | EPDM Rubber / recyclable    |
| Hardness              | Shore A   |
| ASTM Durometer        | 50 - Blue      55 - Black<br>60 - Orange<br>70 - Red  |
| Thickness             | 3/4" (19mm) & 1/2" (12mm)   |
| Triangular Footprint  | 3 point primary surface contact<br>1 point secondary load contact   |
| ASTM D412 Tensile PSI | 1810  |
| ASTM D412 Elongation  | 648   |
| Loading               | Excellent   |
| Performance Info      |     <br>Tested to meet DIN 18032 Part II<br>Tested to meet EN 14904<br>Tested to meet MFMA's PUR standards<br>ASTM 2137 low temperature brittleness, 3 min @ -40 - pass<br>ASTM D395 compression set, 22 hours @ 70c set % -20 |
| U.S. Patent#          | #598,8915   |

#### Aacer Pad Options

| TriPower™ Black   | TriPower™ Red | TriPower™ Orange | EcoDIN       | AacerCush   | AacerFlex   |
|---|---------------|------------------|--------------|-------------|-------------|
|  |               |                  |              |             |             |
| 1/2" (12mm)   | 3/4" (19mm)   | 3/4" (19mm)      | 7/16" (11mm) | 3/8" (10mm) | 3/4" (19mm) |