

# AacerFlex™ VLP

## FLOATING SYSTEMS

Aacer Flooring's popular AacerFlex™ VLP is the low profile version of AacerFlex™. This performance sports floor system meets the ergonomic needs of today's athlete through sufficient force reduction, increased energy return, as well as outstanding ball rebound characteristics. It's ability to utilize multiple pad options and maintain a low profile height makes the AacerFlex™ VLP a versatile system for many applications.



# AcerFlex™ VLP

AcerFlex™ VLP a low profile version of AcerFlex™. This system incorporates a variety of precision engineered pads that integrates load bearing ability with enhanced athletic performance. AcerFlex VLP can be specified for multipurpose rooms, competitive sports applications and dance/aerobics. Available in AcerFlex™, AcerFlex™ TP and AcerFlex™ EN-DIN.

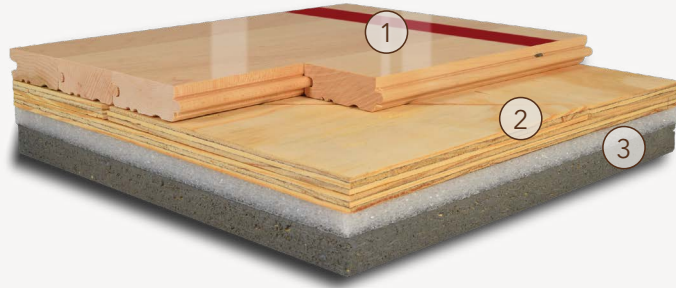

- 1. Precision-milled Acer Maple
- 2. 3/4" (19mm) AcerFlex™ VLP Panel
- 3. 1/4" (6mm) Performance Foam

## WALL BASE

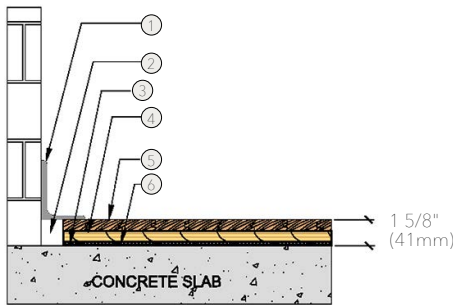

1. 3" x 4" (76mm x 101mm) Vent Cove Base
2. 1 1/2" (38mm) Min. Expansion Space
3. 1/4" (6mm) Performance Foam
4. 3/4" (19mm) AcerFlex™ VLP Panel
5. MFMA Maple Flooring 25/32" x 2 1/4" (20mm x 57mm)
6. 6 mil Vapor Barrier

## THRESHOLD

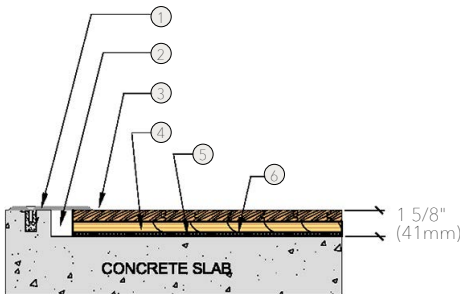

1. 1/4" (6mm) Aluminum Threshold
2. 1 1/2" (38mm) Min. Expansion Space
3. MFMA Maple Flooring 25/32" x 2 1/4" (20mm x 57mm)
4. 3/4" (19mm) AcerFlex™ VLP Panel
5. 1/4" (6mm) Performance Foam
6. 6 mil Vapor Barrier

## EQUIPMENT

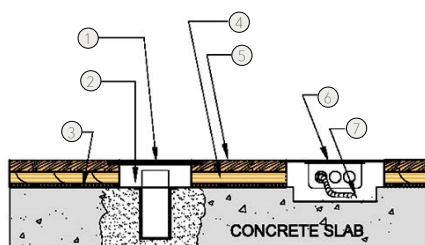

1. Floor Plate
2. 1 1/2" (38mm) Min. Expansion Space Required at all Insert & Electrical Penetrations
3. 6 mil Vapor Barrier
4. 3/4" (19mm) AcerFlex™ VLP Panel
5. MFMA Maple Flooring 25/32" x 2 1/4" (20mm x 57mm)
6. Flush Electrical Box or Scorer's Box
7. Flexible Conduit

Certified



Green Status and LEED Contributors



- FSC® Certified Maple - MRC7
- FSC® Certified Subfloor Components - MRC7
- EQ - 4.2
- Regional Materials - MRC5.1 & 5.2

Optional Versions

AcerFlex™, AcerFlex™ TP, AcerFlex™ EN-DIN

Resilience

1/4" (6mm) Performance Foam  
\*Other pad options available. Contact your Regional Sales Manager.

Slab Depression

1/4" (6mm) Performance Foam  
• 25/32" (20mm) flooring – 1 5/8" (41mm)  
• 33/32" (26mm) flooring – 1 7/8" (48mm)

Subfloor Construction

Plywood

System Type

Floating

Testing Laboratory



Warranty

Lifetime available

*It is the policy of Acer Flooring to continuously improve its line of products. Therefore, Acer Flooring reserves the right to change, modify or discontinue systems, specifications and accessories of all products at any time without notice or obligation to purchaser.*



see us at  
**Sweets.com**

